

# Welcome to the AccessibilityOnline Webinar Series



A collaborative program between the ADA National Network and the US Access Board



The Session is Scheduled to begin at 2:30pm Eastern Time  
We will be testing sound quality periodically

Audio and Visual are provided through the on-line webinar system. This session is closed captioned. Individuals may also listen via telephone by dialing 712-432-3100 code 930098 # (This is not a Toll Free number)

The content and materials of this training are property of the US Access Board and the Great Lakes ADA Center and cannot be used and/or distributed without permission. This program is funded through a contract agreement with the U.S. Access Board. For permission to use training content or obtain copies of materials used as part of this program please contact us by email at [adata@adagreatlakes.org](mailto:adata@adagreatlakes.org) or toll free (877)232-1990 (V/TTY)

[www.AccessibilityOnline.org](http://www.AccessibilityOnline.org)

1

---

---

---

---

---

---

---

---



## Webinar Features



- **Closed captioning** – click **CC** icon (top of screen) or control-F8 and adjust the captioning screen as needed
- **Customize your view** – choose “View” from the menu bar at the top of the screen and choose the layout you prefer from the dropdown menu.
- **Questions** - type and submit questions in the Chat Area Text box or press control-M and enter text in the Chat Area
- **Emotions/Hand-raising:** Please do not use these features during this session

2

---

---

---

---

---

---

---

---

## Presenter

U.S. Access Board



Dave Yanchulis

3

---

---

---

---

---

---

---

---

# Accessible Courthouses

## Session Agenda

- Entrances
- Courtrooms
- Holding Cells

---

---

---

---

---

---

---

---

## New ADA Standards



**DOJ's 2010 standards**  
(mandatory March 15)



Based on the Board's  
ADA-ABA Guidelines (2004)



---

---

---

---

---

---

---

---

## ADA and ABA Standards

• State & Local Courthouses:  
ADA Standards



• Federal Courthouses:  
ABA Standards (GSA)



---

---

---

---

---

---

---

---

## ADA and ABA Standards

§206 Accessible Routes

§231 Judicial Facilities

§808 Courtrooms

§807 Holding Cells



7

---

---

---

---

---

---

---

---

## Courthouse Accessibility

- Too often treated as an afterthought
- Must be integrated into all stages of design, including mock-ups
- Can be achieved without compromising security, sightlines, and other requisites



8

---

---

---

---

---

---

---

---

## Advisory Committee



Courthouse Access Advisory Committee

9

---

---

---

---

---

---

---

---

## Committee Report

Guidance on:

- Meeting the standards
- Best Practices
- Common Errors

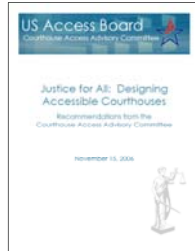

[www.access-board.gov/caac](http://www.access-board.gov/caac)

9

---

---

---

---

---

---

---

---

## Entrances

11

---

---

---

---

---

---

---

---

## Entrances (§206.4)

- Public Entrances: 60% min.
- (plus those serving parking structures, elevated walkways/ tunnels)
- Restricted Entrances: at least 1
- Detainee/ Inmate Entrances: at least 1

12

---

---

---

---

---

---

---

---

## Entrances



### Best practices:

- Minimize elev. at entry/ avoid plinths
- Access to primary entrance
- Door automation (required for Federal)

13

---

---

---

---

---

---

---

---

## Entrances



Plinths often require complex access routes

14

---

---

---

---

---

---

---

---

## Entrances

### Automation of Exterior Doors



### Required:

Federal Courthouses  
(GSA's Public Building Standards)



### Recommended:

Other Courthouses

15

---

---

---

---

---

---

---

---

## Entrances

Bollards and other security barriers cannot obstruct accessible routes (§206.8)



16

---

---

---

---

---

---

---

---

## Entrances

Accessible route required through or around security screen devices (§206.8)



17

---

---

---

---

---

---

---

---

## Restricted Entrances



2-Way Communication Devices:

Visual and audible signals required (§230)

18

---

---

---

---

---

---

---

---

## Detainee/ Inmate Entrances

Exceptions for manual doors operated only by security personnel (§404.1):

- Hardware
- Closing speed
- Opening force

Automatic: only clear width & threshold requirements apply)



---

---

---

---

---

---

---

---

## Courtrooms

---

---

---

---

---

---

---

---

## Scoping

- New Construction: All Courtrooms (§231)
- Alterations: Each altered courtroom (§202)
- Existing: Program Access



---

---

---

---

---

---

---

---

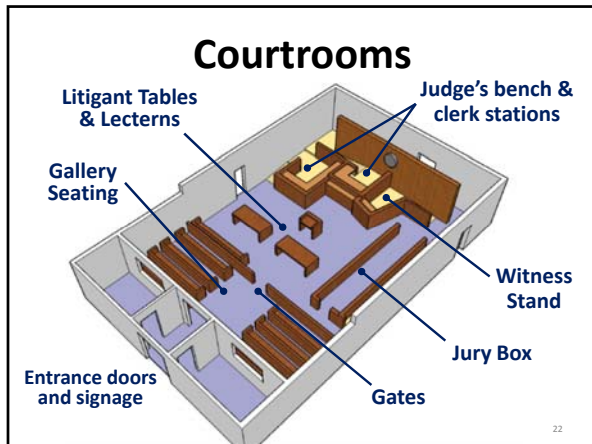

---

---

---

---

---

---

---

---



---

---

---

---

---

---

---

---

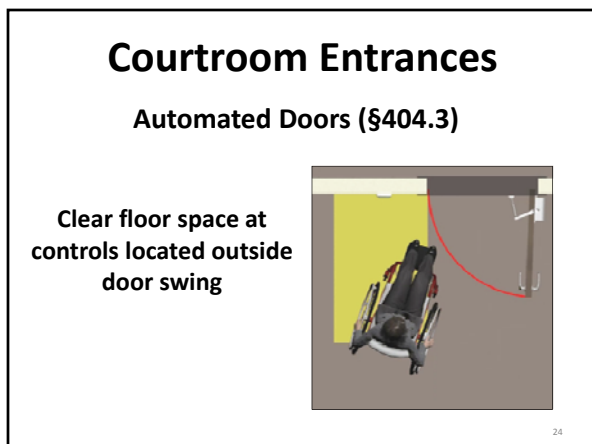

---

---

---

---

---

---

---

---



## Courtroom Entrances

Doors in series (§404.2.6)



48" min. separation between swing of doors 25

---

---

---

---

---

---

---

---

## Courtroom Signage



Courtroom Number/ Labels:  
visual and tactile (§216)

Also required for:

- Other room numbers
- "Permanent" room labels, including restrooms
- Exits
- Floors Levels

26

---

---

---

---

---

---

---

---

## Courtroom Signage

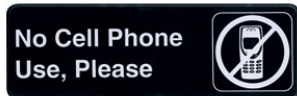

- Visual only: directional and informational signs, rules of conduct
- Exempt: occupant names, building names, temporary signs

27

---

---

---

---

---

---

---

---

## Gallery Seating



28

---

---

---

---

---

---

---

---

## Gallery Seating

Wheelchair spaces required according to total seating capacity (§221)

| <u>Total</u> | <u>W/C Spaces</u> |
|--------------|-------------------|
| 4 – 25       | 1                 |
| 26 – 50      | 2                 |
| 51 – 150     | 4                 |
| 151 – 300    | 5                 |

29

---

---

---

---

---

---

---

---

## Gallery Seating

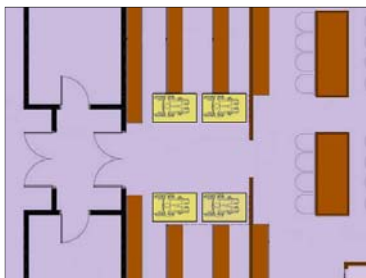

Wheelchair spaces must be located within seating footprint

30

---

---

---

---

---

---

---

---

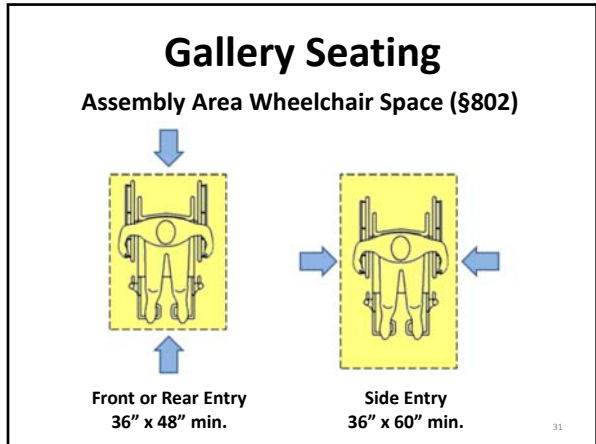

---

---

---

---

---

---

---

---

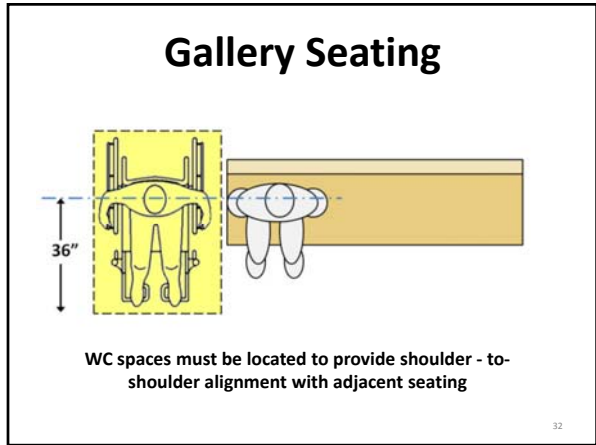

---

---

---

---

---

---

---

---

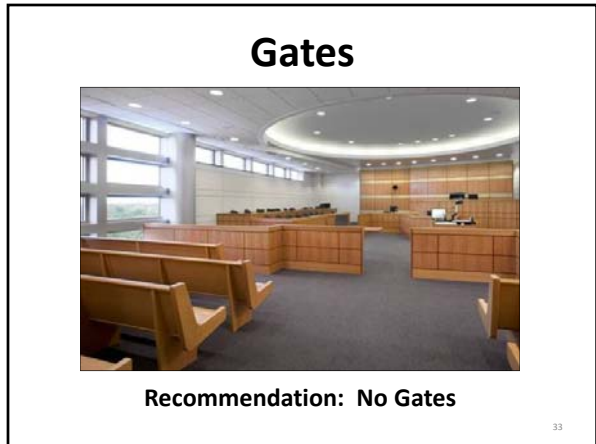

---

---

---

---

---

---

---

---

## Gates (§404)

- 32" min. clear width (1 leaf)
- Smooth surface on push side
- Opening force: 5 lbf max.
- Closing speed (spring hinges - 1.5 sec. min.)
- Compliant hardware



34

---

---

---

---

---

---

---

---

## Jury Box and Witness Stand

- Clear floor space within defined area (removable seats allowed)
- Gates/ enclosures: unassisted access
- Ramp or lift (if raised) – must be permanent
- Not allowed: portable solutions, fold-out/telescoping ramps (except in some retrofits)
- Turning space in areas served by ramp

35

---

---

---

---

---

---

---

---

## Clear Floor Space (§305)

Forward Approach

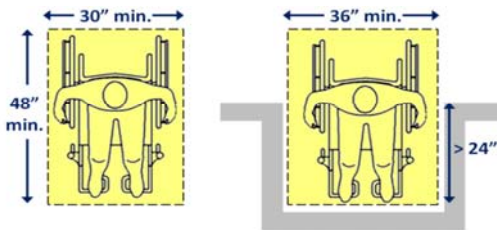

Greater width (36") required where space is confined more than half the depth

36

---

---

---

---

---

---

---

---

## Clear Floor Space

### Side Approach

Greater length (60") required where space is recessed/ confined more than half the width

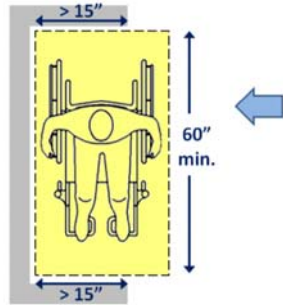

---

---

---

---

---

---

---

---

## Clear Floor Space

### Knee and Toe Clearance

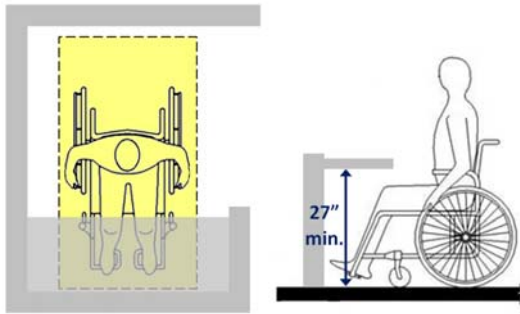

---

---

---

---

---

---

---

---

## Jury Box and Witness Stand

### Alterations:

- If ramp/ lift would obstruct MOE, wheelchair space can be located outside defined area (§808.3)
- Qualified historic facilities – departures allowed where compliance would impact historic integrity (§202.5)

39

---

---

---

---

---

---

---

---

## Jury Box

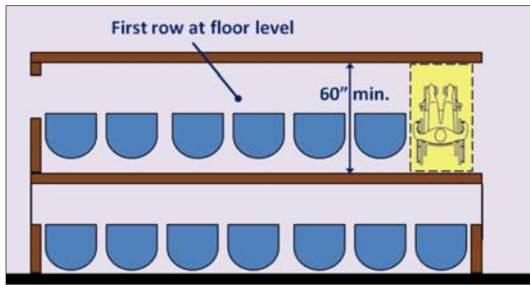

Row at floor level provides easier access

40

---

---

---

---

---

---

---

---

## Jury Box

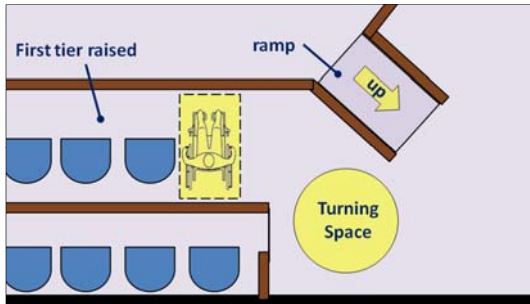

Turning space required on levels served by ramp (or lifts with entry ramps)

41

---

---

---

---

---

---

---

---

## Jury Box

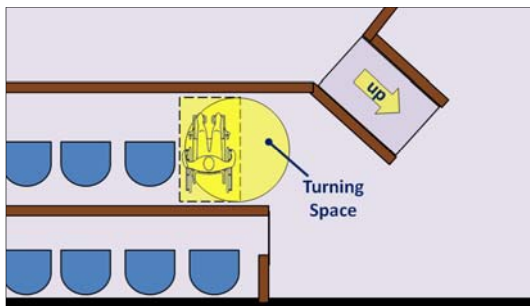

Turning space can overlap WC space (if not serving other locations, such as witness stand)

42

---

---

---

---

---

---

---

---

## Turning Space (§304)

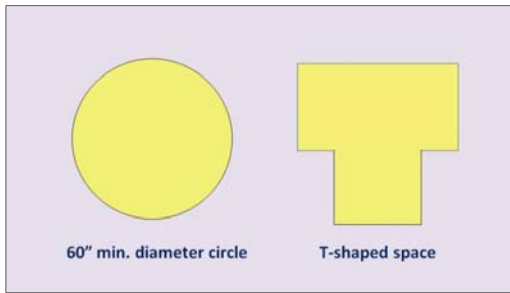

Turning space can be at circular or T-shaped

43

---

---

---

---

---

---

---

---

## Ramps (§405)

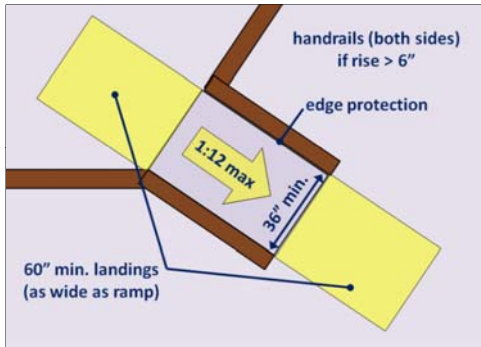

44

---

---

---

---

---

---

---

---

## Jury Box

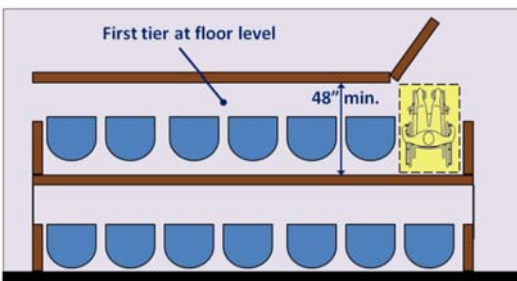

Back-in space requires less space but entry gates often impact usability

45

---

---

---

---

---

---

---

---

## Jury Box

Gates at WC space that do not provide unassisted access should be avoided



- Often heavy due to millwork (> 5 lbf max. opening force)
- Difficult to manually close from within the space

46

---

---

---

---

---

---

---

---

## Jury Box

Another example of enclosure with gate at WC space



47

---

---

---

---

---

---

---

---

## Witness Stand

Witness stand at floor level provides easier access



48

---

---

---

---

---

---

---

---



## Witness Stand

If raised, ramps preferred means of access



49

---

---

---

---

---

---

---

---

## Witness Stand

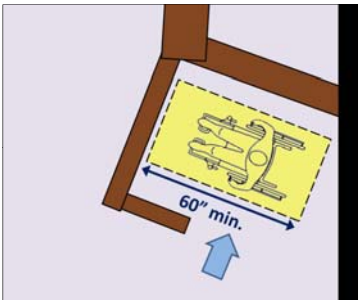

WC space confined at front and back – 60" min. length required for side entry

50

---

---

---

---

---

---

---

---

## Witness Stand

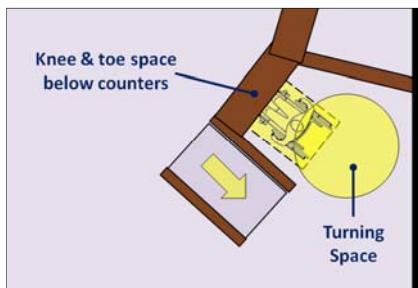

Turning space required on levels served by ramp (or lifts with entry ramps)

51

---

---

---

---

---

---

---

---

## Witness Stand

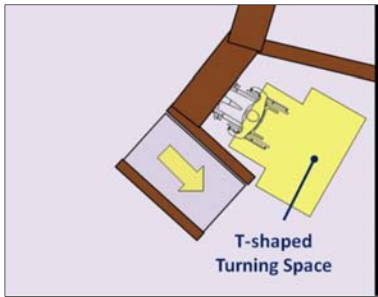

T-shaped turning space (alternative to 60" circle)

52

---

---

---

---

---

---

---

---

## Ramps v. Lifts

Ramps recommended over lifts:

- Preferred by most users
- Independent use, less conspicuous
- Reliable – no maintenance

53

---

---

---

---

---

---

---

---

## Platform Lifts

Considerations:

- Custom design – no standard design for courtrooms
- Architectural finishes and platform/ enclosure details
- Unassisted Operation
- Maintenance/ Repair
- Compliance with §410 and ASME A18.1 Standard

54

---

---

---

---

---

---

---

---

## Platform Lifts

ASME A18.1 Standard  
(2008) has new section  
on Courtroom Lifts

(This edition not yet  
referenced by the ADA  
& ABA standards)



55

---

---

---

---

---

---

---

---

## Lift Drive Systems

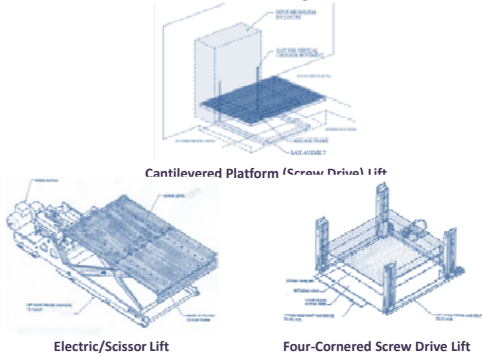

56

---

---

---

---

---

---

---

---

## Platform Lifts

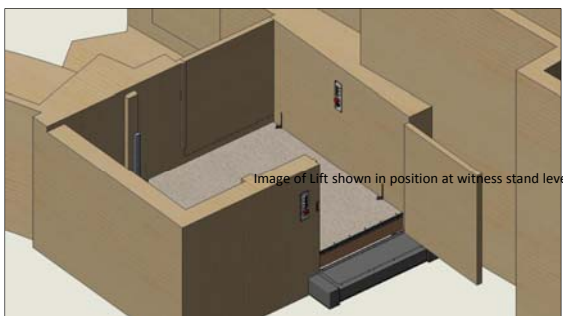

Lift in normal position at level of witness stand

57

---

---

---

---

---

---

---

---

### Platform Lifts

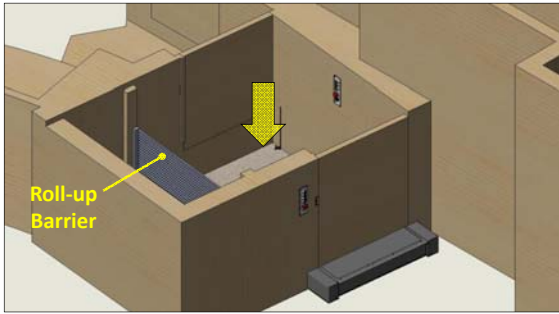

Lift at lower level – doors closed, roll-up barrier extended

---

---

---

---

---

---

---

---

### Platform Lifts

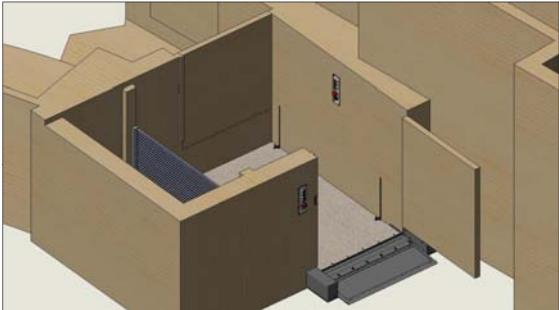

Door open at lower position; automated step/ramp

---

---

---

---

---

---

---

---

### Platform Lifts

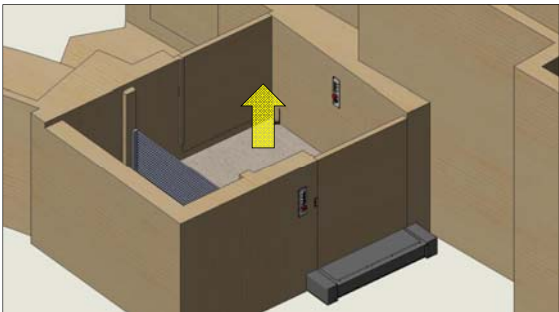

Lift in mid travel (witness stand floor)

---

---

---

---

---

---

---

---

## Platform Lifts

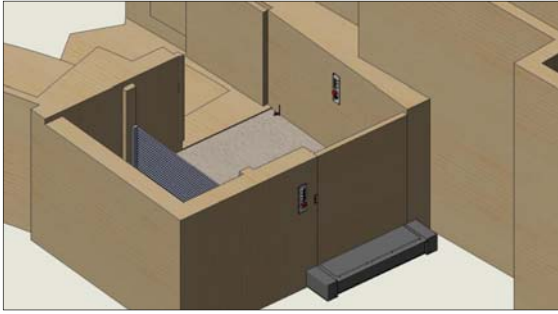

Lift at upper level (judge's bench)

61

---

---

---

---

---

---

---

---

## Platform Lifts



62

---

---

---

---

---

---

---

---

## Platform Lifts



Roll-up Barrier Stowed

63

---

---

---

---

---

---

---

---

## Platform Lifts



Roll-up Barrier Extended

64

---

---

---

---

---

---

---

---

## Platform Lifts

### Recommendations:

- Coordination of millwork and lift design/ installation is essential
- Establish minimum warranty requirements
- Local/ regional service and parts availability

65

---

---

---

---

---

---

---

---

## Judge's Bench/ Work Stations

(including clerk, court reporter, bailiff stations)

- Clear floor space/ knee & toe space
- Work surfaces (28" – 34" height)
- Vertical access (adaptability permitted)

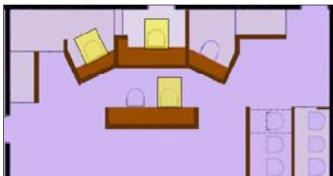

66

---

---

---

---

---

---

---

---

## Judge's Bench/ Work Stations

Ramp or lift can be installed after construction if necessary space/ electrical service provided (§206.2.4)

- Not permitted for jury box or witness stand
- Allowed by IBC (2009) - but not earlier editions
- State/ local requirements may be stricter

67

---

---

---

---

---

---

---

---

## Judge's Bench/ Work Stations

Best practices:

Vertical access provided in construction:

- in all courtrooms or
- at least 1 of each type of courtroom (adaptable access in the rest)

68

---

---

---

---

---

---

---

---

## Judge's Bench

Recommendations:

- Ramp instead of lift
- Installed in construction
- Located outside courtroom (security, decorum)



69

---

---

---

---

---

---

---

---

## Judge's Bench

Ramp location behind wall

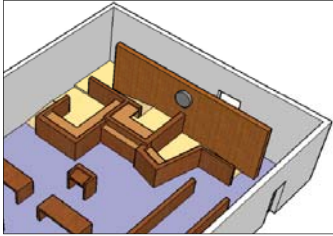

Ottawa County Courthouse  
Grand Haven, Michigan (HDR/FTC+H)

70

---

---

---

---

---

---

---

---

## Judge's Bench

Ramp location behind wall

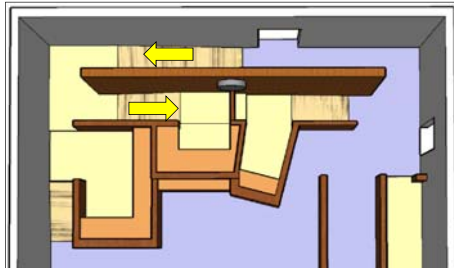

Ottawa County Courthouse  
Grand Haven, Michigan (HDR/FTC+H)

71

---

---

---

---

---

---

---

---

## Judge's Bench

Lift location behind wall



Kent County Courthouse  
Grand Rapids, Michigan (Tower Pinkster/HOK)

72

---

---

---

---

---

---

---

---



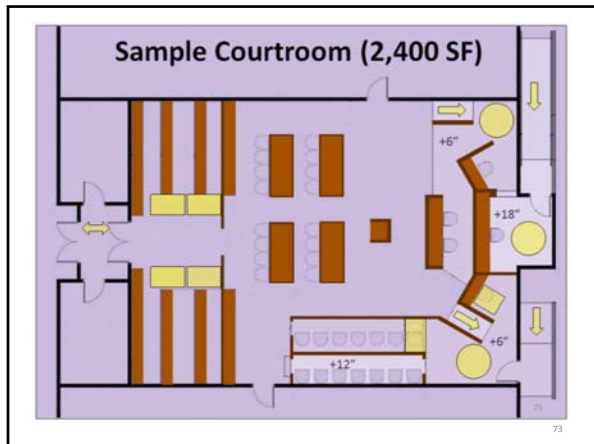

---



---



---



---



---



---



---

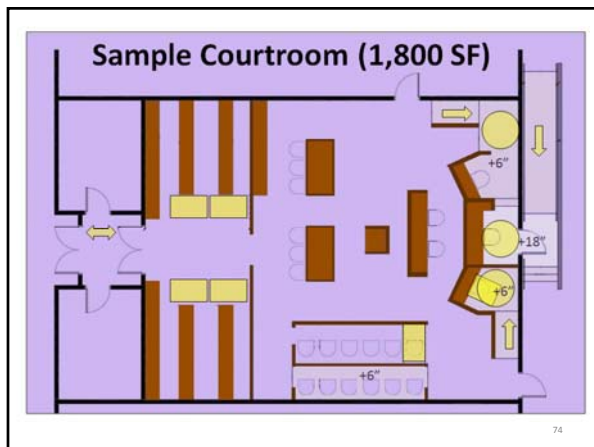

---



---



---



---



---



---



---



---



---



---



---



---



---



---

## Lecterns

Best practice recommendations:

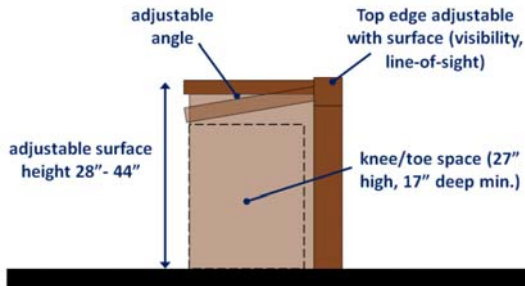

76

---

---

---

---

---

---

---

---

## Assistive Listening Systems

Required in each courtroom (§219)

- Technologies (IR, loop, FM)
- Receivers (number, hearing-aid compatibility)
- Signs



77

---

---

---

---

---

---

---

---

## Assistive Listening Systems

Signs required to indicate the availability of systems



78

---

---

---

---

---

---

---

---

# Holding Cells

---

---

---

---

---

---

---

---

- ### Holding Cells (§231.3)
- Central and Court-Floor holding areas
  - Access to at least one of each type (e.g., male/ female, adult/ juvenile)
  - Each courtroom served by at least one accessible cell
  - Cells may serve more than one courtroom

---

---

---

---

---

---

---

---

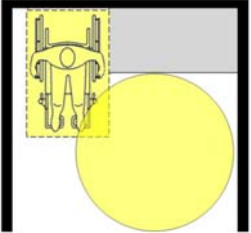
- ### Holding Cells (§807)
- Doors (exceptions if operated only by security personnel)
  - Turning Space
  - Benches (if provided)
- 
- The diagram shows a cross-section of a holding cell. A person is seated on a bench. A yellow circle represents the turning space. A door is visible at the top of the cell.

---

---

---

---

---

---

---

---

## Holding Cells (§807)

Accessible toilet facilities



82

---

---

---

---

---

---

---

---

## Visiting Areas

- Access to counters on both the visitor and the detainee sides
- Method to facilitate voice communication
- Handset with volume control



83

---

---

---

---

---

---

---

---

## Other Courthouse Spaces

- Jury Assembly Rooms
- Jury Deliberation
- Judges' Suites
- Restrooms

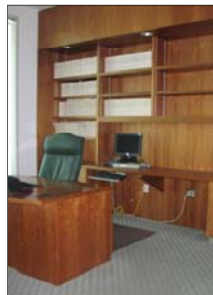

84

---

---

---

---

---

---

---

---

# Questions?

You may type and submit questions in the  
Chat Area Text Box or press Control-M  
and enter text in the Chat Area

85

---

---

---

---

---

---

---

---

## U.S. Access Board

(800) 872-2253 (voice)  
(800) 993-2822 (TTY)

E-mail: [ta@access-board.gov](mailto:ta@access-board.gov)  
[www.access-board.gov](http://www.access-board.gov)

86

---

---

---

---

---

---

---

---

Thank you for participating  
in today's webinar



Next scheduled session:  
"2010 ADA Standards for Accessible Design"  
March 1, 2012

[www.AccessibilityOnline.org](http://www.AccessibilityOnline.org)

877-232-1990 (V/TTY)

87

---

---

---

---

---

---

---

---